

### IMPORTANT INFORMATION

**Note!** Please visit [www.jeld-wen.com](http://www.jeld-wen.com) for additional resources and complete instructions. We have How-To videos and written Product Guides available for most products. Contact us for more information.

#### INCLUDED PARTS

- Interlock Clip

#### PRECAUTIONS AND SAFETY

- Use proper and safe equipment and protective gear as necessary.

#### NEEDED TOOLS

- Putty knife
- Rubber mallet (optional)

### INTERLOCK CLIP REPLACEMENT

1. Open patio door half way and secure.

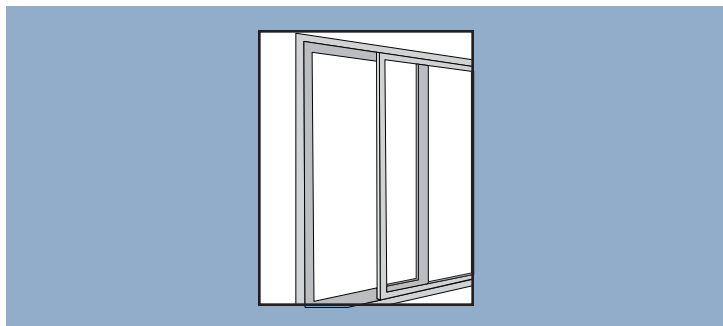

2. Insert the putty knife between the panel and the clip. Gently pry to release the clip from the panel from top to bottom.

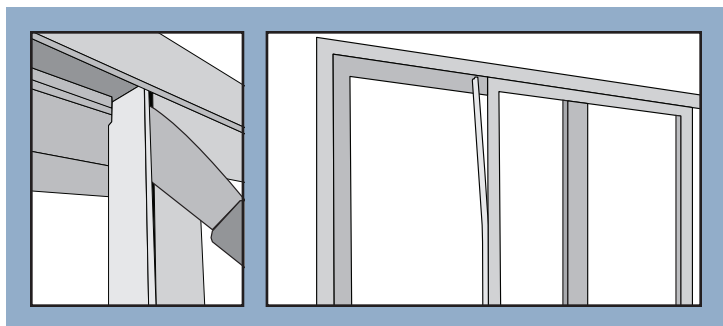

3. Once the interior side is fully released the entire clip can be removed.

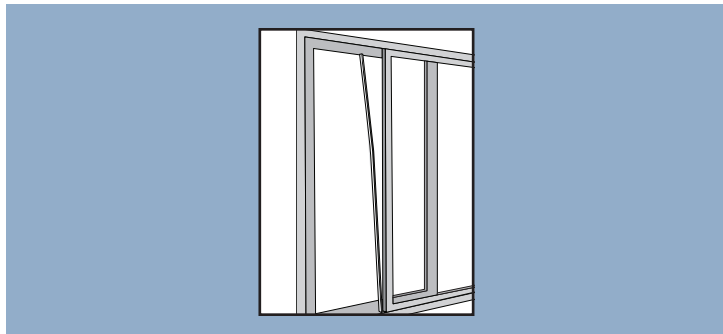

5. Install the new clip by aligning the clip with the top of the panel and seating the exterior side first then firmly pressing the interior to snap into place.

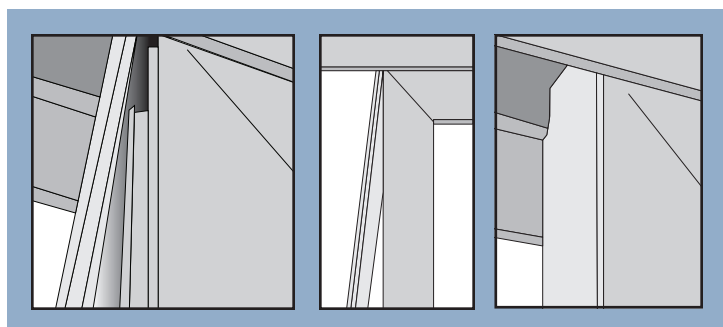

6. Work from the top of the panel to the bottom, seating the exterior side and snap the interior side into place.

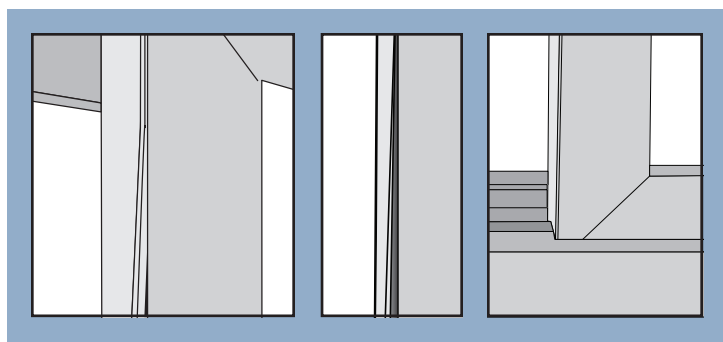

7. Check for proper operation.

The advice offered herein can be done by a homeowner with some mechanical aptitude. If you are unsure, it is recommended that you hire a trained service provider such as a competent and licensed construction contractor or building professional. JELD-WEN disclaims any and all liability associated with the use and/or provision of these instructions. Any reliance upon the information or advice is at the risk of the party so relying. The information contained herein may be changed from time to time without notification.